

Classic Bubble Gum & Candy Machine Instructions

OPERATING INSTRUCTIONS

1. Insert key (taped to base) into lock, turning counter clockwise to unscrew from center rod.
2. Remove top cap.
3. Lift globe from body of unit.
4. Lift body from base, turn upside down to empty coins. Be sure to hold mechanism in place while turning upside down to prevent mechanism falling out.
5. Replace body over center rod onto base.
6. Check timing if necessary by turning dispensing wheel until empty hole is a 6:00 o'clock position.
7. Replace globe over center rod onto body.
8. Add product.
9. Replace top cap and secure with lock by turning clockwise to tighten.
10. DO NOT OVER TIGHTEN!

INSTALLING GUM DISPENSING WHEEL

1. Insert key into lock, turning counter clockwise to unscrew from center rod.
2. Remove top cap.
3. Separate globe from hopper by removing the two screws from the globe retaining clips.
4. Remove brush off plate and lift adjustable wheel from center rod.
5. Place riser into hopper with smooth side and cut out at 6:00 o'clock over hole in hopper.
6. Place gum dispensing wheel over center rod with empty hole at 6:00 o'clock position for proper timing.
7. Place gum brush off plate over gum wheel.
8. Replace and secure globe with the globe retaining clips and screws.
9. Replace top and cap and secure with lock.

HOW TO ADJUST THE ADJUSTABLE CANDY DISPENSING WHEEL

1. Follow steps 1-4 above
2. Loosen the three screws on the metal adjustor.
3. Move the adjustor clockwise to make dispensing hole smaller and counter clockwise to make dispensing hole larger.
4. Tighten the three screws on the metal adjustor after adjusting to desired size.
5. Place adjustable wheel over center rod with empty hole at 6:00 o'clock position for proper timing.
6. Place the brush off plate for the adjustable wheel (vertical springs) over the adjustable wheel.
7. Replace and secure globe with the globe retaining clips and screws
8. Replace top and cap and secure with lock.

Classic Bubble Gum & Candy Machine Instructions

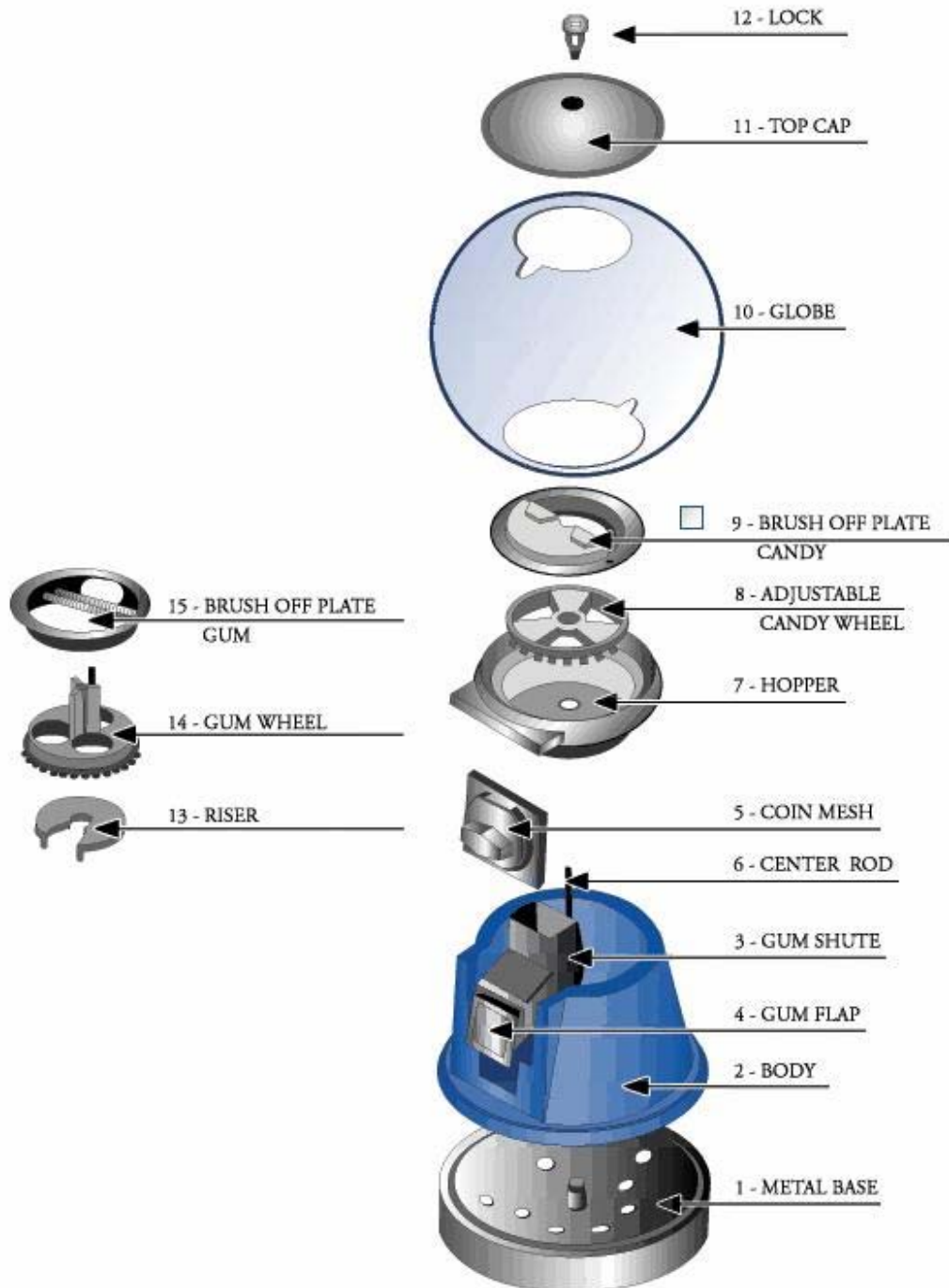

Classic Bubble Gum & Candy Machine Instructions

STAND ASSEMBLY & MACHINE ATTACHMENT

Single Stand Parts: Single top plate, round center post, round disk shape base, 4 colored screws w/ nuts, 8 gold screws or black hex screws, 4 washers if you have all gold screws.

Double Stand Parts: Double top plate, round center post, round disk shape base, 4 colored screws with nuts, 12 screws, either black wide hex screws or gold screws. The assembly for single and double stand is the same except you need to follow the instruction for putting the machines on the stand 2 times for the double stand.

1. PARTS: Place all the parts for you stand out in front of you to ensure you have everything.
2. CENTER POST TO BASE: Take the round center post and place the round shape end into the round disk shape base. Line up the holes and insert the 4 colored screws into each of the holes. Put the 4 nuts on the inserted colored screws and tighten them down tight.
3. TOP PLATE TO CENTER POST: Take the top plate and line up the holes with the holes in the square end of the center post. The holes in the square end of the center post have been pre-tapped so once the holes are lined up with the top plate you put your screws tight in without any other nuts. Put the screws in the designated holes and tighten them down tight. If you have gold screws, use them to attach top plate.
4. PUTTING THE MACHINE ON THE STAND: Undo the lock on the machine and disassemble the machine completely down to the gold base and center post. Place the gold base on the stand and line up the holes between the base and the top plate. The holes on the stand have been pre-tapped so no other nuts are necessary. Once the holes are lined up take the black hex screws (which require no washer) and leave one whole space between each screw. Tighten the base down to the top plate.
5. PUTTING THE MACHINE TOGETHER: When you have the gold base secured on the stand put the machine back together as follows. Place the colored body with the chute door, coin mechanism, and chute guard back on the gold base. Then take the globe assembly with the gold hopper and check the dispensing wheel for proper setting. Be sure hole is lined up directly over chute. Place the globe assembly on top of the colored body. Put your candy in, put the lid back on and tighten your lock back down.

Instructions to make your coin mechanism spin freely:

1. Take the mech. out of the machine and place the mech. with the handle side down and the coin drop facing away from you.
2. Take out the screw in the middle followed by the gear wheel. Then, pull the handle out of the mech. Put the mech. back down the same way.
3. On the left side of the mech. there are 3 screws. First take out the middle screw out followed by 2 pieces (thin slide and big dog).
4. Unscrew all the screws along the outside of the mech. (3 total screws). This will allow you to take off the back plate.
5. In the front plate, take out the 2 pieces in the top left corner (spring and regular dog). Make sure the other piece's (coin carrier) opening is aligned with the coin drop.

Now it's time to start putting the mech. back together. The four pieces taken out of the machine (thin slide, big dog, spring and regular dog) are the ones needed out for the coin mech. to spin freely.

6. First, put the back plate on.
7. Screw back in the 3 screws (2 smaller screws go in the left side, longer screw goes in the right).
8. Put the handle back in. Watch for the flat side of the handle. That side should be facing towards the coin drop.
9. Put on the gear wheel with the 2 arrows facing towards the coin drop. And, out the first screw you took out back in.

Now turn the handle and it should turn with ease, without inserting a coin.

gumball.com 1-800-260-0010